

\$380,000 :: 4 Bedrooms / 2.5 Bathrooms

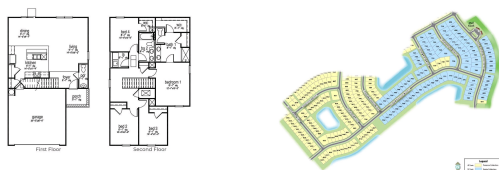

Subdivision: Cane Bay Plantation
Middle School: Berkeley
High School: Berkeley
Square Feet: 1927
Home Style:
Year Built: 2024
MLS ID: 24024574



Description of property at 738 Long Bluff Road:

READY THIS FALL! Welcome to The Aisle with 'B' elevation which features Brownstone colored siding and Black Walnut shakes at the gables with Black shutters and Black front door. This is a 4-bedroom, 2.5-bathroom, 2 story home with a 2-car garage. Entering the spacious Great Room, we find the Family Room, Dining Area, Powder Bathroom, and a wonderful Cook's Kitchen are all together for open living where everyone is a part of everything! This beautiful kitchen features Gray cabinetry, granite counters, a large kitchen island with room for 3 counter height barstools and there's a large pantry too. The stainless-steel Whirlpool appliances include a 5-burner gas range, microwave, dishwasher, and even a refrigerator! The main level of the home features wood inspired flooring that's beautiful and wears like iron - no carpet on the main level in this home! The owner's suite is a great size and has both a Large Walk-in Closet, a second closet. The owner's bath has private toilet, dual vanities with quartz tops, and a huge 5-foot-wide walk-in shower. Additionally, upstairs there is second full bathroom features dual vanities with quartz tops, and a tub/shower combo. The laundry room is conveniently located upstairs with all the bedrooms, so laundry is a breeze Pine Hills in Cane Bay, Summerville, offers a serene suburban lifestyle. Nestled amidst lush landscapes and elegant homes. Residents enjoy nearby parks, shopping, and dining, making it a family-friendly haven with a charming southern atmosphere. Amenities include 3 pools, with a 2-story water slide. Nearby is the largest YMCA on the East Coast, and the community offers easy access to I-26. All new homes include D.R. Horton's Home is Connected® package, an industry leading suite of smart home products that keeps homeowners connected with the people and places they value most. This smart technology allows homeowners to monitor and control their home from their couch or across the globe. Products include touchscreen interface, video doorbell, front door light, z-wave t-stat, and keyless door lock all of which are controlled by an included Alexa Dot and smartphone app with voice! Call to schedule your showing today and start envisioning your new life surrounded by nature's beauty!

Lot features

- Stoop • Laundry Room • Vinyl • Fiberglass • Clubhouse • Park • Pool • Trash
- Ceiling - Smooth • High Ceilings • Kitchen Island • Walk-In Closet(s) • Eat-in Kitchen • Family
- Entrance Foyer • Great • Living/Dining Combo • Loft • Pantry • BCW & SA
- Berkeley Elect Co-Op • Dominion Energy • Thermal Windows/Doors • Window Treatments
- Handicapped Equipped • 0 - .5 Acre • Level • Traditional